

Outline of the Japanese Language Program at Kanazawa University

1. About the Japanese Language Program

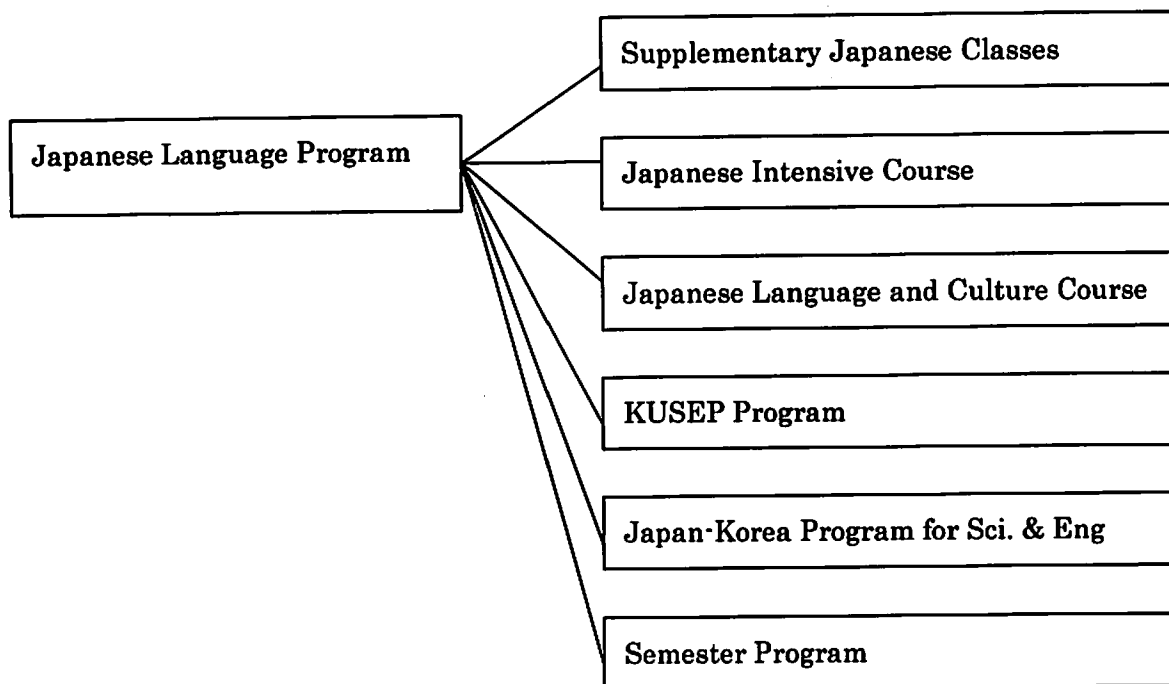

The Japanese Language Program offers classes to faculty students and graduate students (Supplementary Japanese Classes), the Japanese Language and Culture Course for students from the International Student Center, the KUSEP Program, the Japanese Intensive Course, the Japan-Korea Program for Science and Engineering Students and for the Semester Program. In order to respond to the needs of students with various levels of Japanese proficiency, the Program offers a variety of compulsory and elective classes.

All students (new and old) who wish to take this course must apply online through the International Student Center Home Page. (We will only accept online applications.)

<http://isc.ge.kanazawa-u.ac.jp>

2. Who Can Take These Classes?

The Japanese Language Program is open to the following people:

Exchange students at Kanazawa University (faculty students, graduate students, research students, special auditors, etc.) whose native language is not Japanese.

However, in the event that the class does not have the maximum number of students permitted and there is space leftover, the following types of people may be allowed to participate (given in order of priority):

- 1) Foreign researchers affiliated with Kanazawa University
- 2) Foreign employees of Kanazawa University
- 3) Those granted permission by the International Student Center Director

*The family of the above-mentioned people are not eligible for the Program.

(Ishikawa International Lounge is offering free Japanese classes for Ishikawa residents. If your family members are interested, please contact them by email or phone.

Tel: 076-221-9901; Email: iilounge@violin.ocn.ne.jp)

3. About the Curriculum

The regular Japanese classes are compulsory, and the kanji/vocabulary and skill-specific classes are electives.

The Japanese classes are divided into basic, intermediate, and advanced, with each of those further divided into two or three levels for a total of 7 classes (labeled A~F).

The overall purpose of the Program is to improve the students' Japanese in order to ensure their smooth adjustment to university life in Japan.

The kanji/vocabulary classes are also split into 7 levels.

The skill-specific classes are designed for students in the pre-intermediate, intermediate and advanced levels. The pre-intermediate students can take Elementary Reading Comprehension Course. The intermediate students can take Writing I Course, Writing II Course, Listening Course for Lectures and Intermediate Reading Comprehension. The advanced students can take Advanced Reading Comprehension, Report Writing Seminar, Oral Presentation Course, Reading for Specific Purposes (Spring semester), Japanese Affairs Course (Spring semester), Discussion Course (Fall semester) and a course in the preparation of report materials using computers.

There is also a special intensive class (AA class) for A-level students. Since this is an extremely intensive course (ten lessons a week) and takes a lot of your time, students are advised to take the permission of their academic advisor before application. For application information, please contact Prof. Kanae Miura at: kanaemi@kenroku.kanazawa-u.ac.jp

This semester, there are two distinct A classes: A-1 and A-2 class. A-1 is for students who have never studied Japanese and A-2 is for students who know hiragana and have studied up to 13th lesson (or the like) of MINNA NO NIHONGO I.

Some levels have two classes too, but they have no differences except the day and the time. You can choose a convenient one for you. (You can't take both classes.)

All Japanese classes are given in the morning except "Intermediate Reading, Reading for Specific Purposes, Japanese Affairs, Discussion".

All the classes of the Program are held at Kakuma Campus.

	Regular classes	Kanji classes	Skill specific classes	Regular class	Intensive course
A-level	A-1(four classes a week)	Kanji/Vocab.A (once a week)		A-2 (four classes a week)	AA (ten classes a week)
B-level	B(four classes a week)	Kanji/Vocab.B (once a week)			
C1-level	C1(three classes a week)	Kanji/Vocab.C1 (once a week)	Elementary Reading (once a week)		
C2-level	C2(three classes a week)	Kanji/Vocab.C2 (once a week)	Writing I (once a week)		
D-level	D(three classes a week)	Kanji/Vocab.D (once a week)	Writing II (once a week)	Listening (once a week)	Intermediate Reading (once a week)
E-level	E(three classes a week)	Kanji/Vocab.E (once a week)	Report writing (once a week)	Oral Presentation (once a week)	Spring: Reading for Specific Purposes (once a week)
F-level	F(three classes a week)	Kanji/Vocab.F (once a week)	Computer (once a week)	Advanced Reading (once a week)	Spring: Japanese Affairs (once a week) Fall: Discussion (once a week)

4. Placement Test

Upon entering the Program, students are required to take a placement test. As the date varies from semester to semester, further information will be made available upon decision.

The test is made up with the following three sections:

- 1) Kanji test: This test takes 20 minutes. Answer each question as quickly as possible.
- 2) Listening test: It takes about 15 minutes. Fill in the blanks with an appropriate word.
- 3) Grammar, vocabulary and composition test: It takes 45 minutes.

Along with the exam scores, the distribution of the exam scores is taken into consideration when dividing the classes, in order to avoid overcrowding.

For those who could not take the original exam, and for those whose result specified that they should take the exam again, a secondary examination is held. As the date varies from semester to

semester, further information will be made available upon decision.

Students who wish only to take skill-specific classes do not need to take the placement test. In this case, the student should attend the class and have their proficiency level checked by the instructor.

5. About Finalized Class Levels

Initially, the student's class level is determined by the placement exam, but in the event that the instructors feel that they belong in a different class, class changes are permitted during the following period:

Regular Japanese Class: 2 weeks from the beginning of classes

(note: Those students who need credits such as KUSEP student, Japanese language and culture program student etc. have only 1 week before their levels are finalized.)

In order to change class levels, the student must consult with the supervising instructor and receive their permission. If it is decided that a level change is in the best interest of the student, they should then receive the permission of the instructors responsible for both the level they are taking, and the level they want to change to. As a rule, students are allowed to change levels to the degree of one level up or down (the same rule applies for kanji/vocab. and skill-specific classes).

In the event that circumstances (e.g., they were delayed in coming to Japan) force the student to enter the Japanese Program directly without taking the placement exam, they should be aware of the following conditions:

For both the fall and spring semesters, students will be allowed to enter the Japanese Program for up to six weeks after the beginning of classes, on the condition that they can prove they have sufficient reason for missing the beginning of instruction (e.g., they submit a copy of their passport showing their date of entry to Japan). In this case the student will take the placement test individually and be placed in an appropriate class.

Students will not be allowed to enter the program after six weeks have passed since the beginning of instruction. They will have to wait until the following semester.

6. Grading

Grades will be based on exams (at least twice per semester), attendance, and class participation.

Japanese A~D, and *Kanji* Classes :

Exams 70%, Participation 20%, Attendance 10%

Japanese E, F and Skill-specific Classes:

Exams 60%, Participation 30%, Attendance 10%

***If a student receives a total grade of less than 60% they will repeat the same level the following semester.**

***The grade will be available to view online through our online registration system three or four weeks after the class ends. If the grade is either A, B or C, you can proceed to the next level, but if it is D, you have to try the same level again to go up to the next level.**

7. Program Coordinators

For more information about the program, please contact the following program coordinators:

Prof. Masashi Mine TEL.: 264-5777; E-mail: mmine@kenroku.kanazawa-u.ac.jp

Prof. Miho Fukagawa TEL.: 264-5805; E-mail: mihofk@staff.kanazawa-u.ac.jp

Prof. Makiko Matsuda TEL.: 264-5843; E-mail: mts@staff.kanazawa-u.ac.jp

総合日本語プログラム
2011年度秋学期 学年暦
2011 Fall Semester Calender
Integrated Japanese Language Program

2011年	日	月	火	水	木	金	土	
10月							1	
	2	3	4	5	6	7	8	10/5,6(水,木)13:00~プレイスメントテスト (総合教育講義棟210教室) Placement Test(General Education Hall 210)
	9	10	11	12	13	14	15	10/11(火) 授業開始 Classes Start
	16	17	18	19	20	21	22	
	23	24	25	26	27	28	29	10/24(月)13:00~プレイスメント追試 (A3教室) Additional placement test (General Education Hall A3)
11月	30	31	1	2	3	4	5	11/3(木) 文化の日 Culture day (holiday) 11/4(金)~11/7(月) 金沢大学祭 University Festival
	6	7	8	9*	10	11	12	11/9(水)曜日振替(月曜の授業) Monday Schedule
	13	14	15	16	17	18	19	
	20	21	22	23	24	25	26	11/23(水)勤労感謝の日 Labor Thanksgiving Day (holiday)
	27	28	29	30	1	2	3	
12月	4	5	6	7	8	9	10	
	11	12	13	14	15	16	17	
	18	19	20	21	22	23	24	12/23(金)天皇誕生日 Emperor's Birthday (holiday) 12/24(土)~1/3(火) 冬季休業 Winter Vacation
	25	26	27	28	29	30	31	
1月	1	2	3	4	5	6	7	1/9(月)成人の日 Coming-of Age Day (holiday)
	8	9	10*	11	12*	13	14	1/10(火)曜日振替(月曜の授業) Monday Schedule 1/12(木)曜日振替(金曜の授業) Friday Schedule
	15	16	17	18	19	20	21	1/13(金)~1/15(日) 休業(大学入試センター試験) No Classes
	22	23	24	25	26	27	28	
	29	30	31	1	2	3	4	
2月	5	6	7	8	9	10	11	2/10(金)総合日本語コース授業終了 Classes for Fall Semester end
	12	13	14	15	16	17	18	
	19	20	21	22	23	24	25	
	26	27	28	29	1	2	3	
3月	4	5	6	7	8	9	10	
	11	12	13	14	15	16	17	
	18	19	20	21	22	23	24	
	25	26	27	28	29	30	31	

Integrated Japanese Language Program Timetable of Classes Fall Semester 2011

Day	1st Period (08:45~10:15)			2nd Period (10:30~12:00)			4rd Period (14:45~16:15)		
	Class	Instructor	Classroom	Class	Instructor	Classroom	Class	Instructor	Classroom
Mon.	A ①	Ozaki	A2	B	Noda	A2	Japan Affairs II**	Miura	
	A ②	Sato	A3	F (grammar)	Mine	B5			
				Reading I	Saiki	A3			
Tue.				Reading II	Ota	B11			
	A A	Noda	D12	A A	Sato	D13			
	B	Kawachi	A2	A ①	Takagi	A2			
	C 1 ②	Terashita	E16	A ②	Miyanaga	A3			
	D ①	Ozaki	C14	C 1 ①	Sasahara	E12			
	E ①	Noda	D2	C 2 ①	Terashita	E13			
	E ②	Takagi	D3	C 2 ②	Fukagawa	E14			
				D ②	Ozaki	C15			
				Academic Writing*	Yamamoto	B11			
		A A	Konishi	D13	A A	Konishi	D13		
Wed.	B	Okuma	A2	A ①	Matsuda	A2			
	C 2 ①	Shikita	E13	A ②	Tanaka	A3			
	Writing II*	Matsuda	C6	C 1 ①	Okuma	E12			
	Report Preparation	Okazawa	IMC room2	C 1 ②	Sasahara	E16			
				C 2 ②	Miyanaga	E14			
				D ①	Ryokai	C14			
				D ②	Mine	C15			
				E ①	Shikita	D2			
				E ②	Fukagawa	D3			
				F (reading)	Yagi	B2			
Thu.	A A	Sasahara	D13	A A	Miura	D13			
	Kanji D	Kawachi	A2	A ①	Miyanaga	A2			
	Kanji E	Yagi	A3	A ②	Kawachi	A3			
	Writing I	Fukagawa	C7	Kanji B	Tanaka	C5			
				Kanji C1	Ichinose	C4			
				Kanji C2	Matsuda	A4			
				Academic Listening*	Ota	D14			
				Reading III*	Miura	IMC room1			
Fri.	A A	Sasahara	D13	A A	Yagi	D13			
	C 1 ②	Takagi	E16	B	Takagi	A2			
	C 2 ①	Miyanaga	E13	C ①	Kawachi	E12			
	C 2 ②	Yagi	E14	D ①	Tanaka	C14			
	F (Listening & Speaking)	Fukagawa	C2	D ②	Miyanaga	C15			
	Oral Presentation*	Mine	C8	E ①	Yagi	D2			
				E ②	Konishi	D3			
				Kanji A	Matsuda	A3			
			Kanji F	Fujita	B2				
	A A	Shikita	D13	A A (KanjiA)	Matsuda	A3			

< Classroom >
A,B,C,D,E,F:
General Education Lecture Hall
IMC:
Information Media Center

Classes begin on
October 11, 2011 (Tue.)
Classes end on
February 10, 2012 (Fri.)

※ *Italic letters* are classes in charge of the Full-time staff of the International Student Center.

①: first Class, ②: Second Class (There is no difference between except the day and time)

* indicate that these classes are also held as "Japanese B" course of the "General Education" for the undergraduate foreign students.

** indicate that this class is also held as "Japan Affairs I " courses of the "General Education" for the undergraduate foreign students.

**Integrated Japanese Language Program
(Faculty of Medicine)
Timetable of Classes Fall Semester 2011**

Place : Japanese Language Course Room
Faculty of Medicine Building F, Takaramachi Campus

Classes: Introductory Level(≒ the lower level of Japanese A level)
Elementary Level(≒ the higher level of Japanese A level)
Intermediate Level(≒ Japanese B-C1 level)

Schedule:

	1st Period (08:45~10:15)	
Day	Class	Instructor
Mon.	Introductory	Koshino
Tue.	Elementary	<i>Fukasawa</i>
	Intermediate	<i>Mine</i>
Wed.	Introductory	Koshino
Thu.	Elementary	<i>Mine</i>

Classes begin on October 11, 2011 (Tue.)
Classes end on February 10, 2012 (Fri.)

総合日本語プログラム
教科書リスト Textbook List

2011年4月

クラス	著者名	書名	出版社	ISBN	価格
A-1,S-2, AA		Minna no Nihongo I, Textbook	3A Network	9784883191024	2,625
A-1,S-2, AA		Minna no Nihongo I, Grammatical Note	3A Network		2,100
B,AA		Minna no Nihongo II, Textbook	3A Network	9784883191031	2,625
B,AA		Minna no Nihongo II, Grammatical Note	3A Network		2,100
Japanese for faculty of Med.I	Yamazaki Yoshiko and Doi Mitsuru	Hakase I, Basic Japanese for Students. New Edition	3A Network	9784883194056	2,100
Japanese for faculty of Med.II	Yamazaki Yoshiko and Doi Mitsuru	Hakase II, Basic Japanese for Students. New Edition	3A Network	9784883194063	2,625
総合C1	金沢大学留学生センター	ともだちと話そう	(授業開始後、クラスで先生から買ってください)		
総合C2	文化外国語専門学校(編)	文化中級日本語I第2版 CD付	文化外国語専門学校	なし	3,150
総合C2	文化外国語専門学校(編)	文化中級日本語I 練習問題集 改訂第3版	文化外国語専門学校	なし	1,260
総合D	文化外国語専門学校(編)	文化中級日本語II 第2版 CD付	文化外国語専門学校	なし	3,465
総合D	文化外国語専門学校(編)	文化中級日本語II 練習問題集	文化外国語専門学校	なし	1,260
総合E	宮原彬	留学生のための時代を読み解く上級—日本語読解から会話・作文へ—	スリーエーネットワーク	987-4-8839-384-4	2,000
総合F(読解)	梅田 望夫 著	『ウェブ進化論—本当の文化はこれから始まる』	ちくま新書	4-480-06285-8	798
総合F(文法)	なし(ハンドアウト)				
総合F(聞・話)	なし(ハンドアウト)				
漢字A, 漢字B KanjiA, KanjiB	坂野永理, 池田庸子, 品川 恭子, 渡嘉敷恭子	KANJI LOOK AND LEARN	ジャパンタイムズ		1,890
漢字A, 漢字B KanjiA, KanjiB		キャンパスノート6号漢字罫200字30枚 Kanji notebook (Campus Note No.6)	コクヨS&T(Kokuyo S&T)		150
漢字C1 KanjiC1	坂野永理, 池田庸子, 品川 恭子, 渡嘉敷恭子	KANJI LOOK AND LEARN	ジャパンタイムズ		1,890
漢字C2 KanjiC2	佐藤保子, 佐々木仁子	留学生のための漢字の教科書 中級 700	国書刊行会	4336050295	1,680
漢字D	佐藤保子, 佐々木仁子	留学生のための漢字の教科書 中級 700	国書刊行会	4336050295	1,680
漢字E	なし(ハンドアウト)				
漢字F	なし(ハンドアウト)				
作文 I	なし(ハンドアウト)				
作文 II	なし(ハンドアウト)				
レポート	浜田麻里, 平尾得子, 由井紀久子	『大学生と留学生のための論文ワークブック』	くろしお出版	9784874241271	2,625
初級読解	創作集団にほんご(著), 武田 聡子(監修)	マンガで学ぶ日本語表現と日本文化—多辺田家が行く!!	アルク	475741630X	2,100
中級読解	三浦昭(編), 岡まゆみ(著)	『中・上級者のための選読の日本語』	ジャパンタイムズ	9784789009157	2,730
上級読解	なし				
口頭発表	東海大学留学生教育センター	『日本語口頭発表と討論の技術』	東海大学出版会	9784486013549	2,625
講義の聴解	産能短期大学(編)	『講義を聞く技術』(産能短大)	産能大学出版部	なし	2,310
コンピュータによる論文作成	なし				

- **Attendance**

In order to pass a course, students must attend two-thirds of all class sessions. (A student attending less than two-thirds will be failed). However, when attendances are not enough, namely less than two-thirds of all class sessions, for the reasons listed below, a student will have a chance of passing on condition that overall evaluation earns him or her a passing grade.

1) When registration for a course was delayed for a valid reason approved by the International Student Center.

→ A student may pass on condition that attendances exceed two-thirds of classes given after his or her registration, instead of two-thirds of all classes given for the course.

2) When a student is hospitalized for injury or illness

3) When Japanese lessons are scheduled at the time as student's major studies

4) Other valid reasons approved by the International Student Center

- **Tardiness**

When a student arrives to class 15 or more minutes late, the student is considered tardy and two tardies will constitute one absence.

When a student arrives to class 45 or more minutes late, the student is considered absent.

- **Periodic tests**

Students must take periodic tests (midterm and final examinations) on the scheduled dates.

Dates for taking tests cannot be changed for any personal reason.

However, if a student fails to take tests as scheduled for the reasons listed below, the student may be allowed to retake tests on other dates:

1) Illness or injury

2) Family illness, injury or other emergencies

3) Obstacle caused by research for the student's major subject

4) Delay or interruptions of transportation services

5) Other valid reasons approved by the International Student Center

If students find out that they cannot take tests on specified dates, they will have to contact their instructors as soon as possible.

(Please refrain from cheating, dishonesty or other unethical conduct.

If found guilty of such acts, you will be automatically failed for all courses taken in the semester during which the act took place, and will not receive course credit.)

★ 出席

出席率必须达到全部课程的三分之二以上方才能合格。

(如出席率未达三分之二为不合格。)

但如因下列原因不能出席,即便是出席率未达三分之二,如综合成绩达到合格点也算合格。

- 1 因由留学生中心认可的正当理由,课程登录过晚
→并非全部课程数,如登录后的课程数出席率达到其三分之二,也可能合格。
- 2 因伤病住院
- 3 因专业课程和日语课程时间相冲突
- 4 因其他由留学生中心所认可的正当理由

★ 迟到

2次15分钟以上的迟到视作一次缺席、45分钟以上的迟到视作缺席。

★ 定期考试

- 1) 请如期参加定期考试(期中考试、期末考试)。

考试的时日不会因为个人原因而改变。

但是因下列原因不能在指定时日参加考试的情况,之后也能参加补考。

1. 因伤病
2. 因亲属的伤病死亡等
3. 因专业研究的原因
4. 因交通的误时、堵塞、停运等
5. 因其他由留学生中心所认可的正当理由

如明白不能如期参加考试,请尽早与老师联系。

- 2) 请一定不要舞弊。

如果在考试中有舞弊等不正当行为、本学期所修所有课程以不合格处理。

総合教育棟（1号館，2号館，講義棟）平面図

2階 ・ 共通教育学務係

室番	室名	収容人数
241	A1講義室	262人
246	A2講義室	40人
247	A3講義室	64人
249	A4講義室	64人
210	CALL実習室	30人

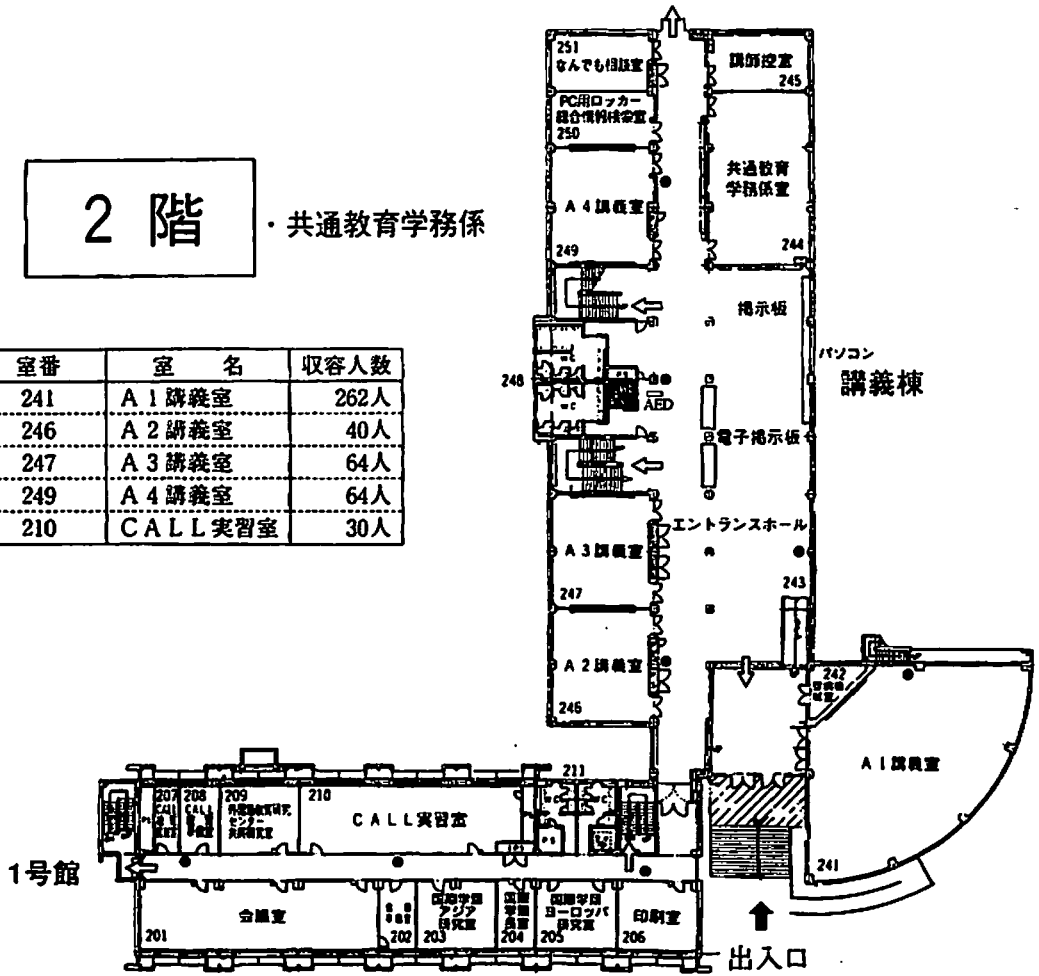

1階 ・ 共通教育管理係

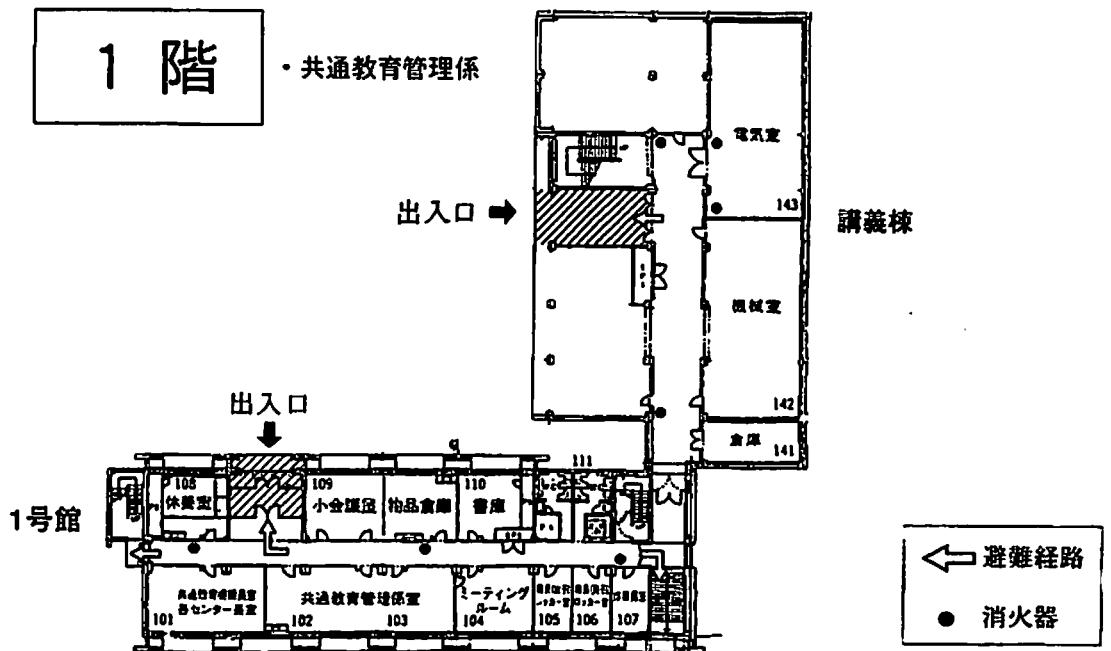

3 階

室番	室名	收容人数
341	B 1 講義室	262人
346	B 2 講義室	40人
347	B 3 講義室	100人
348	B 4 講義室	100人
349	B 5 講義室	64人
350	B 6 講義室	64人
351	B 7 講義室	64人
353	B 8 講義室	64人
354	B 9 講義室	64人
361	B 10 示範教室	154人
345	B 11 演習室	18人
364	B 12 演習室	21人
369	B 14 講義室	30人
377	B 15 講義室	36人

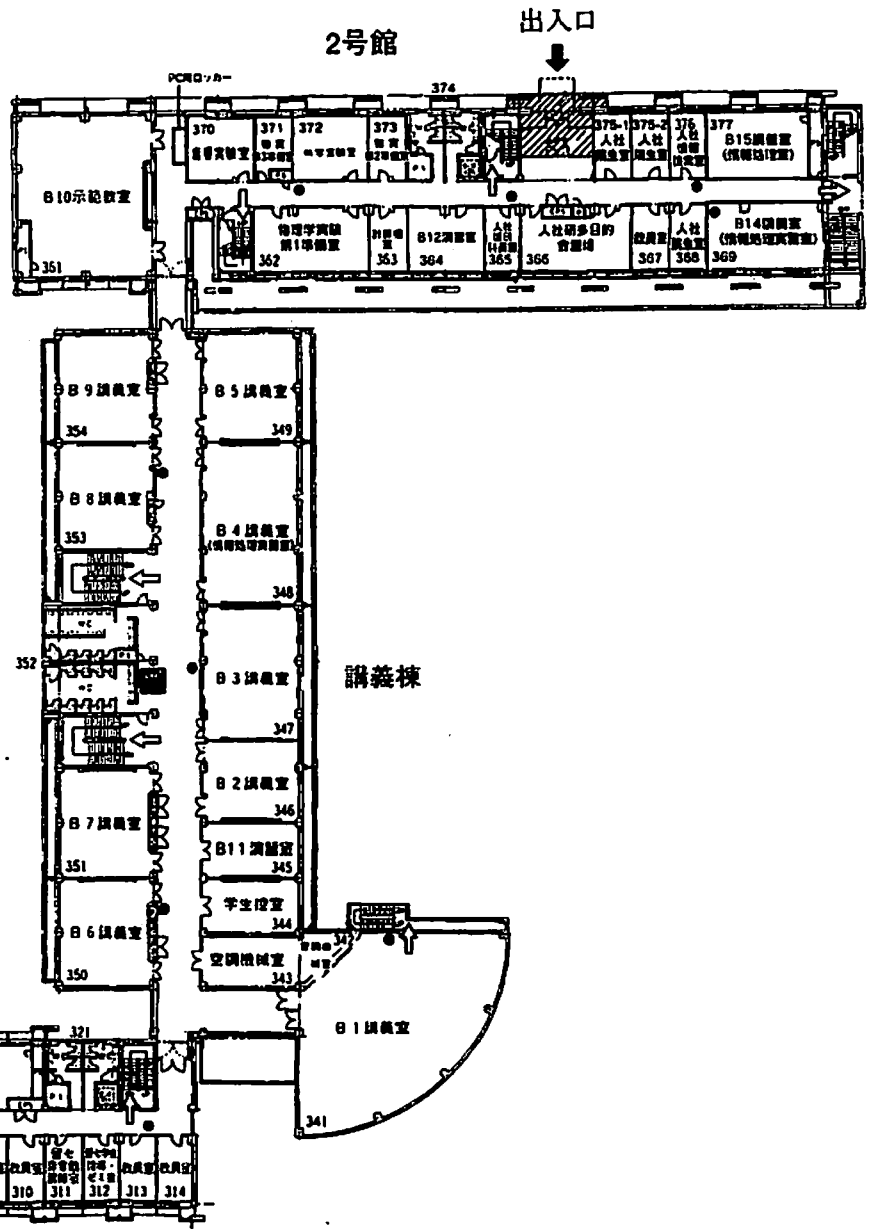

1号館

← 避難経路

● 消火器

4 階

室番	室名	収容人数
441	C1 講義室	262人
445	C2 講義室	87人
446	C3 講義室	87人
447	C4 講義室	87人
448	C5 講義室	87人
449	C6 講義室	64人
450	C7 講義室	64人
452	C8 講義室	64人
453	C9 講義室	64人
461	C10 示範教室	154人
444	C11 演習室	18人
463	学生自習室	21人
470	C14 演習室	27人
471	C15 演習室	21人

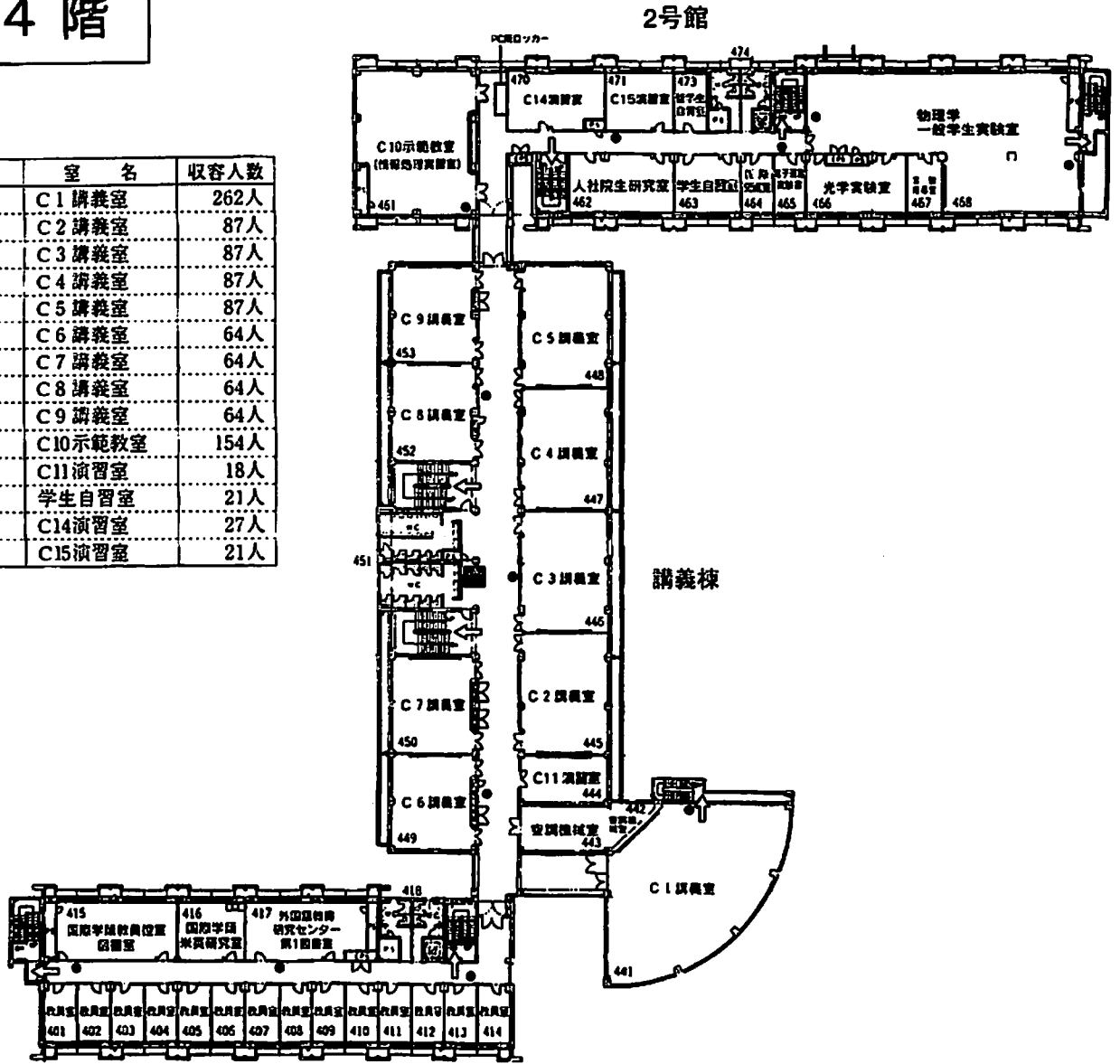

1号館

5 階

室番	室名	収容人数
541	D 1 講義室	40人
542	D 2 講義室	40人
543	D 3 講義室	40人
546	D 4 講義室(AV)	121人
548	D 6 講義室	64人
549	D 7 講義室	64人
551	D 8 講義室	64人
552	D 9 講義室	64人
561	D 10 講義室	154人
545	LL教室	56人
562	D 11 演習室	10人
563	D 12 演習室	40人
564	D 13 演習室	27人
569	D 14 講義室	21人
572	D 15 演習室	21人
547	D 16 演習室	18人

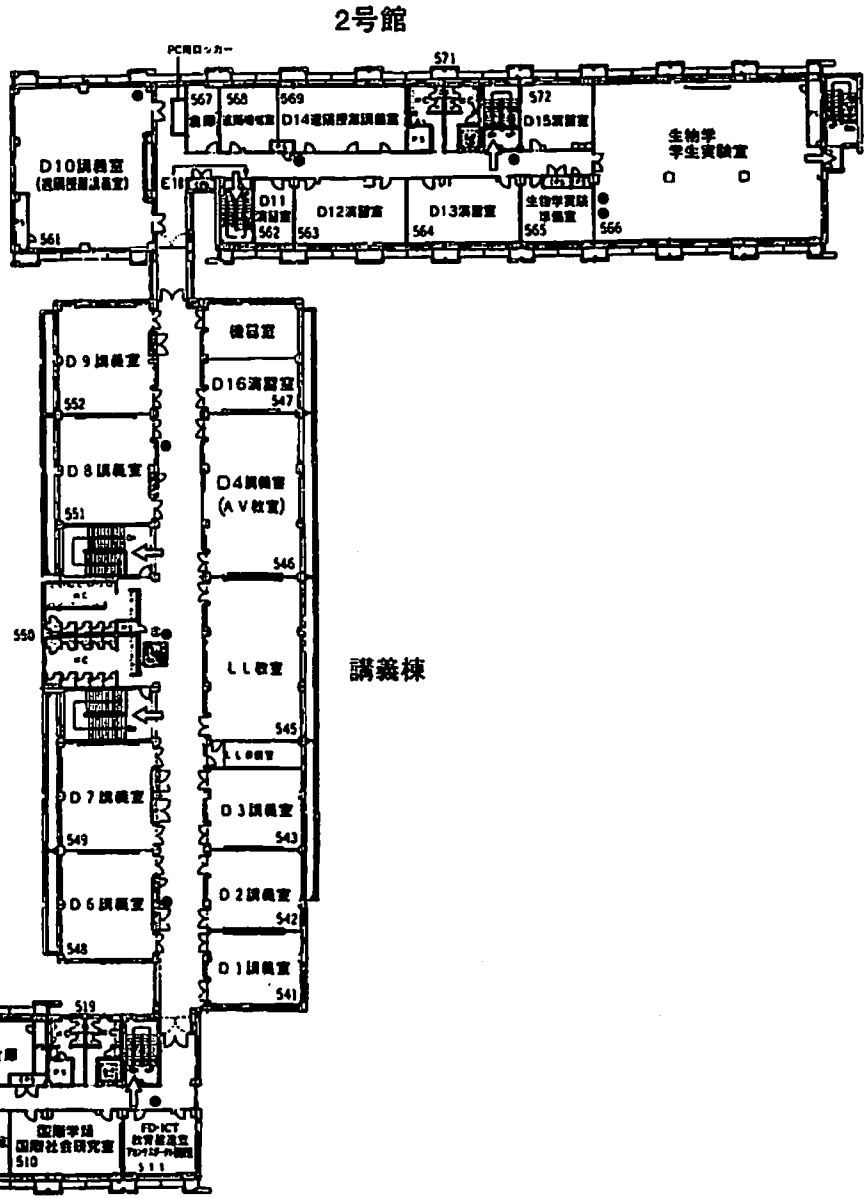

1号館

← 避難経路

● 消火器

6階

室番	室名	収容人数
614	E1 講義室	50人
661	E10 示範教室	154人
665	E12 演習室	21人
666	E13 演習室	21人
667	E14 演習室	21人
676	E16 演習室	16人

E10 示範教室へは、
講義棟5階から2号館へ渡る。

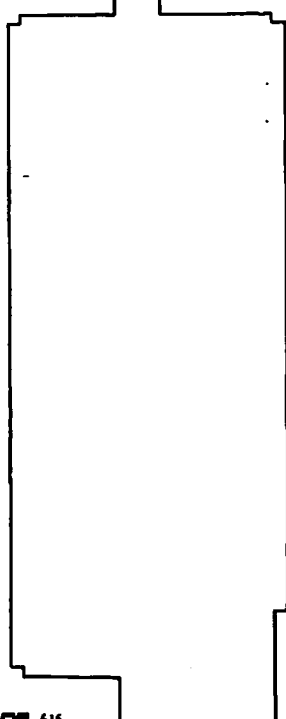
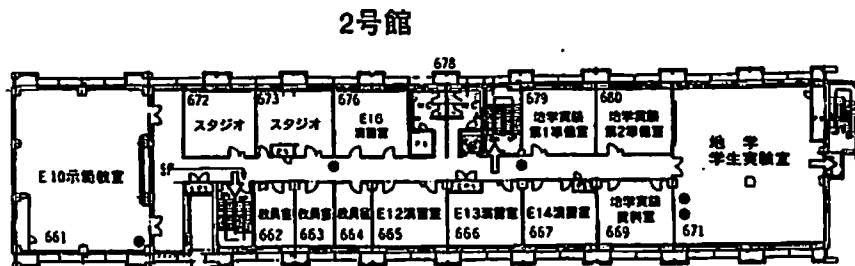

講義棟 (5階建)

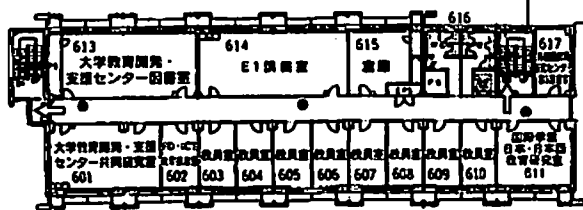

1号館

